



0800 527 337

PRELIMINARY - NOT FOR CONSTRUCTION
Site contours & drainage scaled from
council records - Scheme plan is subject to
council approval & site survey

Client:
Shore Homes
Proposed Residence for
John & Betty Canham at
12 Tuangi Street, (Lot 141)
Long Bay

SITE PLAN

1:100 @ A1 1:200 @ A3

Notes

- 1) All dimensions and underground service locations to be checked on site prior to commencement of work.
- 2) Do not scale from drawings, if in doubt, ask the designer.
- 3) Construction to comply with NZS 3604, local body bylaws and the NZ building code.
- 4) These drawings are only to be used for the purpose they were supplied. No reproduction of these plans is permitted without the written approval of Lifestyle Architectural Services.
- 5) These drawings are subject to copyright & remain the property of Lifestyle Architectural Services.
- 6) Refer to the MasterSpec attached

Drawing Revision

11 - 01 Aug 2014 - Scheme, Site / Floor plans

DBE I MINABV NOT EOB CONSTRICTION

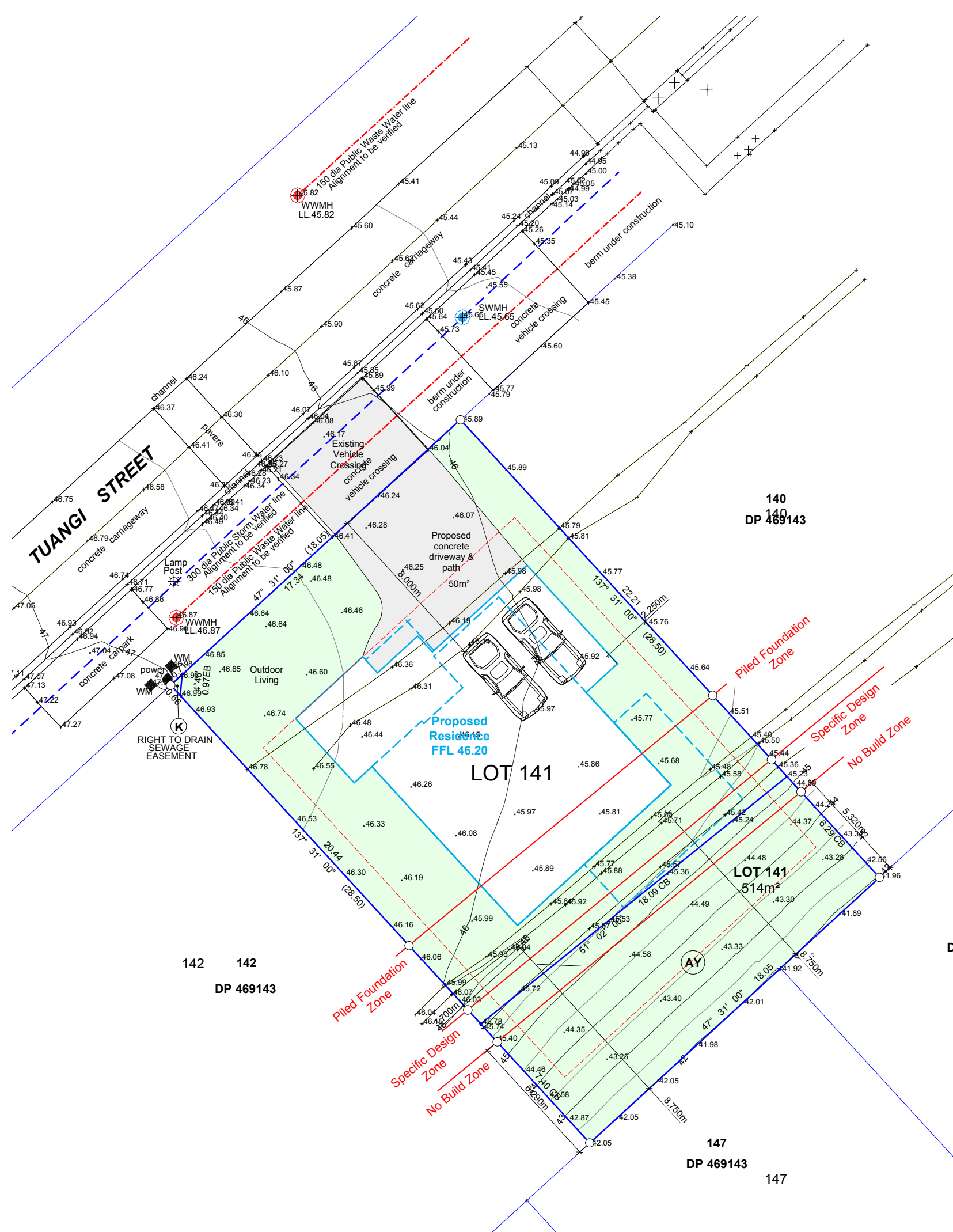

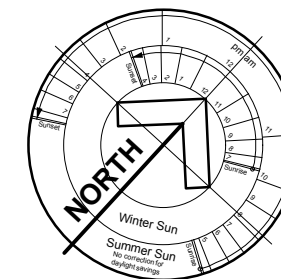

Lower Floor Area: 139m²
Upper Floor Area: 101m²

Total Area:240m²



Visit our web site
www.las.co.nz
0800 527 337

PRELIMINARY - NOT FOR CONSTRUCTION
Site contours & drainage scaled from
council records - Schemeplan is subject to
council approval & site survey

Client:
Shore Homes
Proposed Residence for
John & Betty Canham at
12 Tuangi Street, (Lot 141)
Long Bay

FLOOR PLANS

Notes

- 1) All dimensions and underground service locations to be checked on site prior to commencement of work.
- 2) Do not scale from drawings, if in doubt, ask the designer.
- 3) Construction to comply with NZS 3604, local body bylaws and the NZ building code.
- 4) These drawings are only to be used for the purpose they were supplied. No reproduction of these plans is permitted without the written approval of LifeStyle Architectural Services.
- 5) These drawings are subject to copyright & remain the property of LifeStyle Architectural Services.
- 6) Refer to the MasterSpec attached

Drawing Revision

11 - 01 Aug 2014 - Scheme, Site / Floor plans